

TATTNALL COUNTY

Board of Commissioners

JACKIE C. TRIM
Chairman

FRANK H. MURPHY
County Manager

SHEILA R. MILLS
County Clerk

TOM A. PETERSON IV
County Attorney

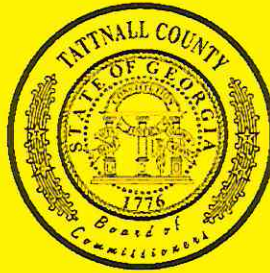

RICKY C. JARRIEL
District 1

BOBBY KENNEDY
District 2

G.W. THOMPSON
District 3

WAYNE TATUM
District 4

WILLIAM J. (BILL)
KICKLIGHTER
District 5

NOTICE OF PUBLICATION OF PROPOSED ABANDONMENT OF A SECTION OF COUNTY ROAD SYSTEM

PLEASE TAKE NOTICE THAT THE TATTNALL COUNTY BOARD OF COMMISSIONERS ("BOC") HAS DETERMINED THAT A SECTION OF THE COUNTY ROAD SYSTEM HAS CEASED TO BE USED BY THE PUBLIC TO THE EXTENT THAT NO SUBSTANTIAL PUBLIC PURPOSE IS SERVED BY IT OR THAT ITS REMOVAL FROM THE COUNTY ROAD SYSTEM IS OTHERWISE IN THE BEST PUBLIC INTEREST. THE ROAD IS JACK JACKSON ROAD, IN PARTICULAR THAT SECTION OF JACK JACKSON ROAD BEGINNING AT ITS INTERSECTION WITH L.E. STANFIELD ROAD AND TERMINATING WHERE JACK JACKSON ROAD ENDS WITHIN A TRACT OF LAND CONSISTING OF APPROXIMATELY 122 ACRES, WHICH IS MORE PARTICULARLY DESCRIBED BY THE TATTNALL COUNTY TAX ASSESSOR ON MAP AND PARCEL NO. 092 004. A COPY OF A SKETCH OF THE SECTION OF JACK JACKSON ROAD WHICH IS UNDER CONSIDERATION FOR ABANDONMENT IS ON FILE AT THE BOC OFFICE AT 108 W. BRAZELL STREET, REIDSVILLE, GEORGIA, 30453, FOR INSPECTION BY THE PUBLIC. THE BOC WILL HOLD A PUBLIC HEARING ABOUT THIS MATTER AT 10:00 AM ON THE 1ST DAY OF JUNE, 2023 IN THE COMMISSION MEETING ROOM ON THE 2ND FLOOR OF THE TATTNALL COUNTY COURTHOUSE, 108 W. BRAZELL STREET, REIDSVILLE, GA 30453. THE PUBLIC IS WELCOME TO ATTEND. IF SUCH SECTION OF JACK JACKSON IS ABANDONED, IT SHALL NO LONGER BE A PART OF THE COUNTY ROAD SYSTEM AND THE RIGHTS OF THE PUBLIC IN AND TO SUCH SECTION OF ROAD AS A PUBLIC ROAD SHALL CEASE.

THIS 4th DAY OF MAY, 2023.

TATTNALL COUNTY BOARD OF COMMISSIONERS

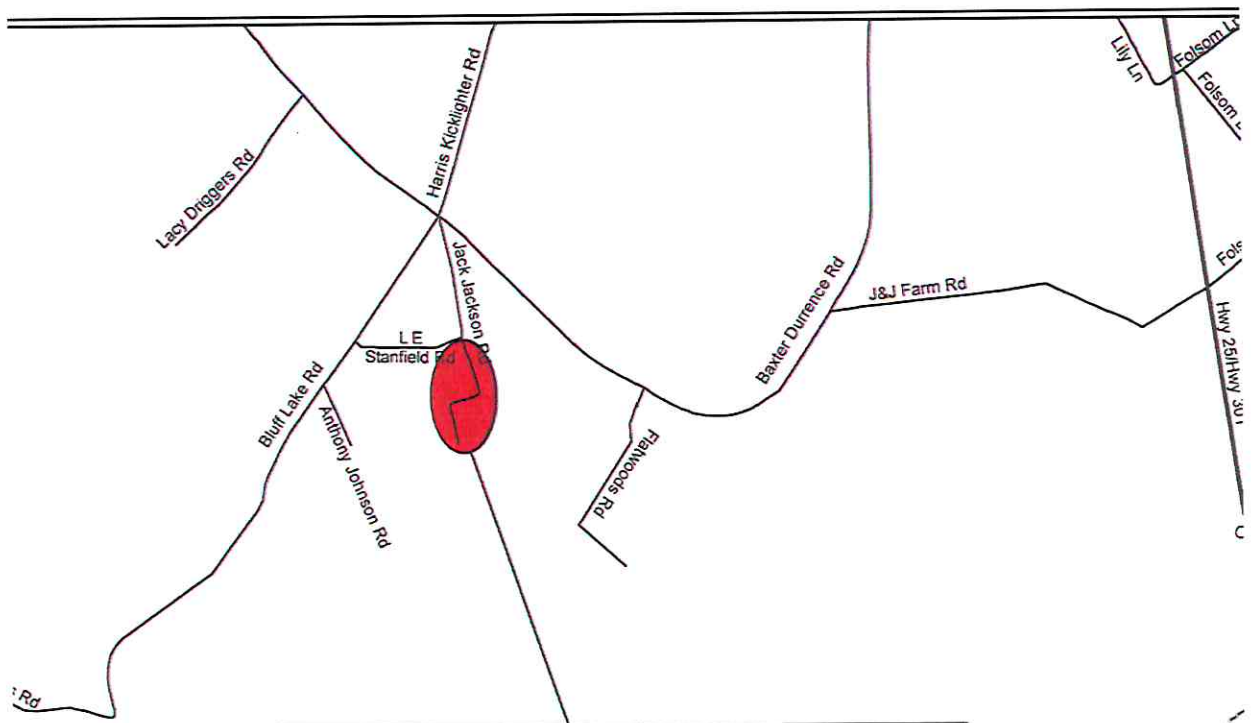

PORTION OF JACK JACKSON
ROAD TO BE CLOSED
THE ROAD TO REMAIN OPEN
FROM BAXTER DURRENCE ROAD
TO L E STANFIELD ROAD

LOCATION SKETCH

Legend: — State Highway — City Limits

— Road — Railroad

Prepared By:
Tattall County
Altamaha RC
June 13, 2018

TATTALL COUNTY, GEORGIA ROAD MAP BOOKLET

4,000 2,000 0 4,000 8,000 Feet

Page 18 of 19



"The data sets represented here-in are presented to the user with the understanding that, because of the nature of some GIS datasets, there is no guarantee of completeness or accuracy. Conclusions drawn from, or actions taken on the basis of this data are the sole responsibility of the user."